



TONGZHOU DRY BIOCHEMISTRY CATALOGUE

Hangzhou Tongzhou Biotechnology Co., Ltd.

ABOUT US

HANGZHOU TONGZHOU BIOTECH CO., LTD. is a leading provider of *in-vitro* diagnostics (IVD) that integrates a complete business operation, from R&D, manufacturing to marketing.

Tongzhou biotech has specialized R&D center and facility, standardized laboratory and top-notch production equipment as well as the implementation of ISO13485 quality system, which provides reliable guarantee for product development and production quality. From navigating the regulatory environment to regular communication from the time of order to delivery, we are known for excellence in quality and service.

We are an innovators in diagnostic area. Have launched a series of POCT rapid products, including antigen & antibody biological materials, women's health inspection, detection of infectious diseases, drug of abuse test series, tumor markers and cardiac markers detection.

Our mission is to improving the health of human beings, hoping to provide more convenient, efficient and complete solutions for the field of Rapid Test as well as POCT. Make best efforts to provide better products and services to the world-wide.





CONTENTS

- 01 Blood Lipid Analysis Meter
- 02 Hemoglobin Analysis Meter
- 03 Multi-function Analysis
- 05 Urinalysis Reagent Strips
- 07 Biochemistry Reagents
- 08 Alcohol Testing

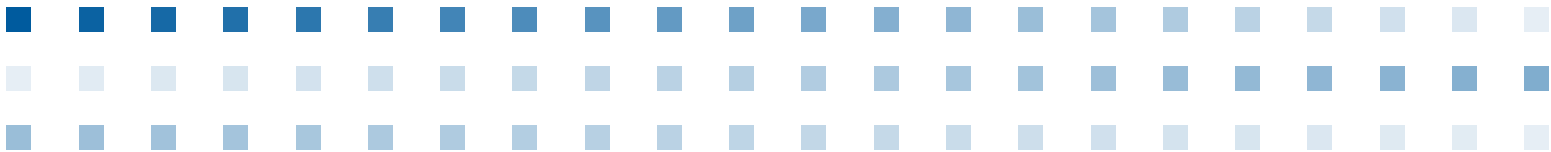



Blood Lipid Analysis Meter



Hemoglobin Analysis Meter



Multi-function Analysis

Blood Lipid Analysis Meter

Advantages

Rapid test

Quick test in 120 seconds

Convenient

Test 3 items in 1 Device

Micro specimen

35 μ L of whole blood (capillary and venous), plasma and serum

portable

Can be operated at home

Economic

Get the same accuracy result with less cost

Intelligent

Link the printer to print results

Analysis item

Total Cholesterol (TC)

High Density Lipoprotein Cholesterol (HDL)

Triglycerides (TG)



LPM-102

Calculated item

Low Density Lipoprotein (LDL)

TC/HDL Ratio

Product specification

Methodology	Reflectance Photometer
Measurement Range	TC:2.59-12.93 mmol/L (100-500 mg/dL, 1 mmol/L=38.66mg/dL) HDL:0.39-2.59 mmol/L (15-100mg/dL, 1mmol/L=38.66mg/dL) TG:0.51-7.34mmol/L (45-650 mg/dL, 1mmol/L=38.66mg/dL)
Specimen	Whole blood(capillary and venous),plasma and serum
Power Source	3xAAA batteries
Battery Endurance	After cycle charge 300 times,electric quantity reduce 30%
Units of Measurement	mmol/L, mg/dL
Memory	500 records
Automatic Shut Off	5 minutes after displaying results
Meter Size	135* 66*19mm(L*W*H)
Weight	90g
Meter Storage Conditions	0-55°C;≤90% RH
System Operating Conditions	10-35°C;0-90% RH ;height<seal-level 2000m
Test strip Storage Conditions	2~30°C;≤90% RH
Warranty Period	2 years
Meter Shelf Life	4 years
Test Strip Shelf Life	18months

Hemoglobin Analysis Meter

Advantages

Rapid test

Test result in 15 seconds

Micro Specimen

Only need 10µL Whole blood
(peripheral and venous human whole blood)

Long Endurance

Removable 3xAAA batteries
with low power consumption

Intelligent Data

Use data cable to sync data with PC



BHM-102

Analysis item

Hemoglobin HCT

Product specification

Methodology	Reflectance photometer
Measurement Range	HB:4.5-25.6 g/dl, 45-256 g/L, 2.8-15.9mmol/L
Specimen	Whole blood(capillary and venous)
Power Source	3xAAA batteries
Battery Endurance	Approximately 1000 tests
Units of Measurement	g/dL,g/L, mmol/L
Memory	1000 records
Automatic Shut Off	5 minutes after last use
Meter Size	136*65*25mm(L*W*H)
Weight	90g
Meter Storage Conditions	0-55°C;≤90% RH
System Operating Conditions	10-40°C;≤90% RH ;height <altitude 2000m
Test strip Storage Conditions	2~30°C; ≤ 90% RH
Warranty Period	2 years
Meter Shelf Life	5 years
Test Strip Shelf Life	2 years

Multi-function Analysis

Advantages

Rapid test

Glucose in 5 seconds

Uric Acid in 30 seconds

Easy Operation

Automatic strip ejection

Intelligent Data

Independent statistics
within Glucose and Uric Acid

Intelligent Recognition

Automatically recognize
different test item



GUM-101

Analysis item

Glucose / Uric Acid

Product specification

Methodology	Electrochemistry Method
Measurement Range	Glu: 20~600mg/dL(1.1-33.3mmol/L) UA: 3~20mg/dL(179-1190umol/L)
Specimen	Fresh capillary or venous whole blood
Power Source	One 3.0V CR2032 lithium battery
Battery Endurance	Approximately 1,000 tests
Units of Measurement	mmol/L, mg/dL, umol/L
Memory	Glu: 50 records; UA: 50 records
Automatic Shut Off	1 minute after displaying results
Meter Size	84.7*52*18mm(L*W*H)
Weight	50g
Meter Storage Conditions	0-55°C; ≤90% RH
System Operating Conditions	8-37°C; 0-90% RH ; altitude 3000m
Test strip Storage Conditions	10~30°C
Warranty Period	2 years
Meter Shelf Life	5 years
Test Strip Shelf Life	2 years

Multi-function Analysis

Advantages

Rapid test

Quick test in 120 seconds

Convenient

Test 9 items in 1 Device

Micro specimen

At most 35μL of whole blood (capillary and venous), plasma and serum

Bluetooth

Use bluetooth to sync data with phone and bluetooth printer conveniently

Long Endurance

Removable 4xAA batteries with low power consumption

Intelligent chip

High-performance measurement



GULP-101

Analysis item

Total Cholesterol (TC)

High Density Lipoprotein Cholesterol (HDL)

Triglycerides (TG)

Glucose (BG)

Blood Pressure (BP)

Uric Acid (UA)

Heart Rate (HR)

Calculated item

Low Density Lipoprotein (LDL)

TC/HDL Ratio

Technical Specifications

Specimen type	Fingertip blood, whole blood (capillary blood and venous whole blood), serum or plasma
Specimen volume of Lipid	Approx. 35μL
Specimen volume of Glucose	Approx. 1μL
Specimen volume of Uric Acid	Approx. 3μL
Power	4xAA batteries
Memory	Each item 500 sets of records, each set of records including test
Power saving mode	The meter shuts down automatically within 4 minutes
Volume	152* 123* 48mm (L*W*H)
Weight	About 365g
System operating conditions	10-35°C, <80%RH, altitude less than 3048 meters
Storage and transportation conditions	0-55°C, <90% RH, (50-106)kPa

Urinalysis Reagent Strips

- ◇ Options of 3 mm, 4 mm or 5 mm wide strips offering flexibility for budget users as well as those looking for better visual experience.
- ◇ Option of equipment based or visual reading giving flexibility to the users.
- ◇ ACR (mALB/CRE Ratio) available with urine analyzers.



U011-01~14 (1st Generation)



U012-01~11 (2nd Generation)

- ◇ Crystal clear differentiation between different shades for accurate results.
- ◇ Good ascorbic acid anti-interference ability.
- ◇ Consistent results with least variations.
- ◇ Better liquid absorption overcoming dripping problems.

Significance of Urinalysis Tests lies primarily in first-line diagnostics. Routine testing of the urine allows determination of the complete urine status, helps in the diagnosis of a wide range of disease, enabling treatment to be started early.

Recommended Combinations

LEU & NIT: For urinary tract infection diagnosis
PRO & BLO / PRO & GLU / ACR
 (mALB/CRE Ratio) :For renal diseases diagnosis
KET & GLU: For diabetes diagnosis
URO & BIL: For liver disease diagnosis

Urinalysis Strips

Measurement : Qualitative / Semi-quantitative
Specimen : Urine
Read Time : 30 -120 Seconds
Shelf life : 24 Months
Storage Temperature : 2-30 °C

Clinical Significance

Parameter	Clinical Significance
Ascorbic Acid (ASC)	High levels of ASC affect the test results of other parameters, indicate re-testing.
Bilirubin (BIL)	Elevated BIL levels indicate different forms of liver diseases such as hepatitis.
Blood (BLO)	Presence of BLO indicates a number of pathologies including kidney damage or urinary tract.
Glucose (GLU)	Presence of GLU provides diagnostic value for diabetes and acute renal failure.
Ketone (KET)	Elevated KET levels indicate diabetes, starvation, vomiting, and febrile states.
Leukocytes (LEU)	Presence of LEU indicates kidney or urinary tract infection or possibly a tumor.
Nitrite (NIT)	Presence of NIT indicates infection including urinary tract infection.
pH	Alkaline pH(>8) values suggest urinary tract infection.
Specific Gravity (SG)	Elevated SG levels indicate liver disease, excessive loss of free water, or congestive heart failure.
Calcium (CA)	Elevated CA levels indicate metabolic bone diseases like osteoporosis.
Creatinine (CRE)	Elevated CRE levels indicate different forms of renal diseases.
Protein (PRO)	Elevated PRO level is a frequent symptom in renal diseases.
Urobilinogen (URO)	Elevated URO levels may indicate disturbance of liver functions, cirrhosis, and viral hepatitis.
Microalbumin (ALB)	Elevated ALB levels indicate diabetic glomerular microangiopathy or diabetic nephropathy.

Albumin / Creatinine ratio (ACR) table

The following table is the ratio automatically in the machine on the basis of the test results.

Micronutrient albumin (mg/L)	Creatinine (mg/dL)				
	10	50	100	200	300
10				<30mg/g	
30					
80	>300mg/g		30 -300mg/g		
150					

Ordering Information

Cat. No.	Product	Specimen	Format	Pack	Analytes	CE Status
U011-01~14	Urinalysis Reagent Dipsticks - 1~14 parameter	Urine	Dipstick	100 T	ASC, BLO, BIL, URO, KET, GLU, PRO, NIT, LEU, pH, SG, ALB, CRE, CA	CE
U012-01~11	Urinalysis Reagent Dipsticks - 1~ 11 parameter				ASC, BLO, BIL, URO, KET, GLU, PRO, NIT, LEU, pH, SG	

Biochemistry Reagents

Women's Health

Cat. No.	Product	Specimen	Format	Pack	CE Status
I072-5004	Vaginal pH	Vaginal Secretion	Panel	10/25/40T	CE

Drugs of Abuse

Cat. No.	Product	Specimen	Format	Pack	Cut-Off	CE Status
D062-1002		Urine	Cassette	25/40 T	0.02%	CE
D062-1014	Alcohol (ALC)	Urine	Panel	25/40 T	/	CE
D062-1001		Urine	Dipstick	50 T	/	CE
D062-8001	Alcohol (ALC)	Oral Fluid	Dipstick	25/50 T	0.02%	CE
D062-8002		Oral Fluid	Cassette	25 T	0.02%	CE
D062-9002	Breath Alcohol (With/Without Blow bag)	Breath	Cassette	15T/20 T	0.08%	CE
O017-9014	Breast Milk Alcohol	Breast Milk	Panel	25 T/40 T	0.01%	CE
O017-9001		Breast Milk	Dipstick	50T	0.01%	CE
D063-1002	γ -Hydroxybutyric acid (GHB)	Urine	Cassette	25 T	10 μ g/mL	CE
D064-1011	Adulteration Rapid Test	Urine	Dipstick	25 T	/	CE

Others

Cat. No.	Product	Specimen	Format	Pack	Cut-Off	CE Status
O018-9002	Sperm Concentration	Sperm	Cassette	2 T	15 million/mL	CE



For Easy Alcohol Testing

Breath Alcohol Rapid Test

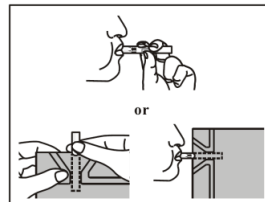
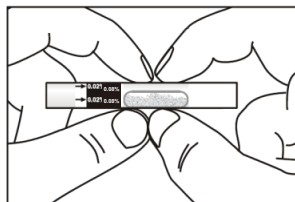
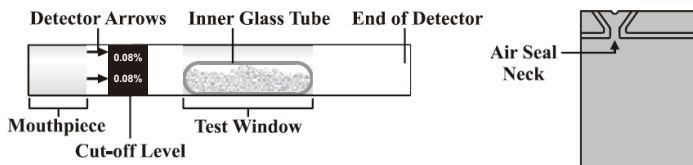

Hold the middle of the Test. Firmly squeeze the Test to break the Inner Glass Tube.

- Blow hard into the Mouthpiece.
- Blow hard in one continuous breath for 12 seconds or until the blow bag is completely inflated

2 min



NEGATIVE: Majority of the crystals remain yellow-orange.



POSITIVE: Majority of the crystals turn green-blue.

- Compare the color of majority of the crystals.

Urine Alcohol Rapid Tests

- ◇ Fast result (3-5 minutes)
- ◇ Non-invasive sample collection
- ◇ Easy visual interpretation
- ◇ High accuracy
- ◇ Simple one step operation
- ◇ Clear color chart for different concentrations



Dip In The Urine For 15 Seconds

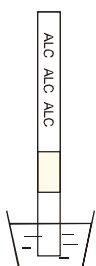

Dip In The Urine For 15 Seconds

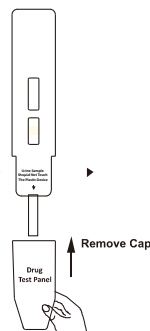
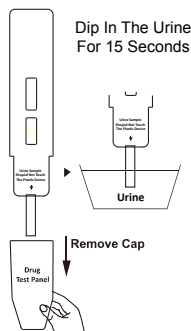

3 drops of specimen

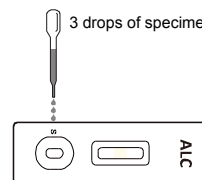

3-5 Minutes





Hangzhou Tongzhou Biotechnology Co., Ltd.

Room 102, Building 4, No. 191, Xintian Road, Yunhe Street,
Linping District, Hangzhou, China.

Email: Tongzhou01@tongzhoubio.com / service@tongzhoubio.com